

GT-TC206X-HXXX-LX

G-SWITCH

Operating Force
 A=180gf
 B=250gf
 C=130gf

Switch Height (mm)
 H045=4.5mm
 H052=5.2mm
 H068=6.8mm

Switch lifetime (Force)
 L05=50,000 Cycles(B)
 L1=100,000 Cycles(A, C)

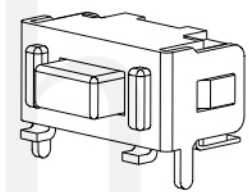

G-Switch Specification:
 Operating temperature range : -30°Cto+85°C
 Rating : 50mA.12V DC
 Insulation resistance : 100MΩ min.100V DC
 Dielectric strength : 250V AC for 1 min
 Contact resistance : 100m Ω max.
 Travel:0.25±0.1mm

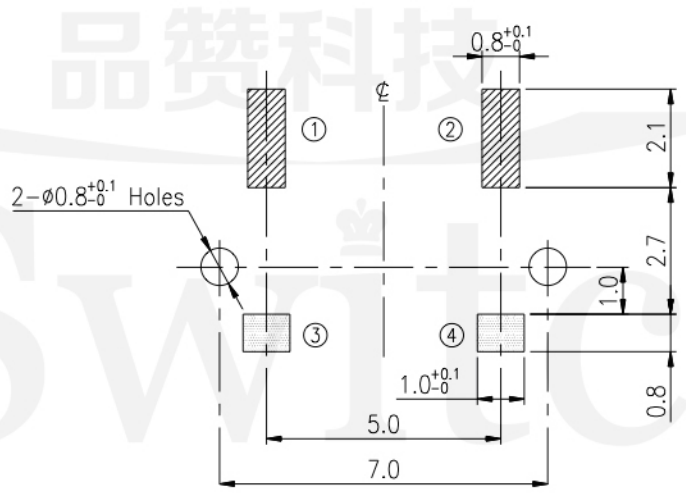
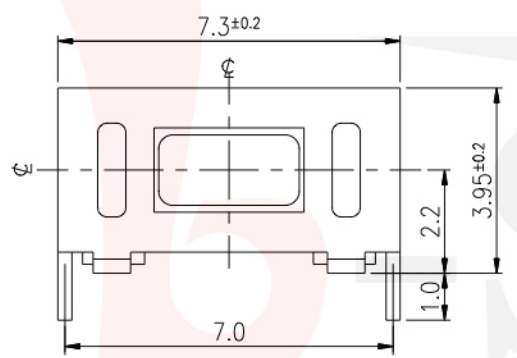

P.C.B LAND DIMENSION

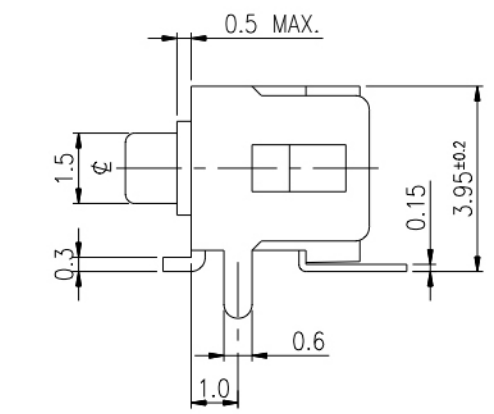

SCHEMATIC

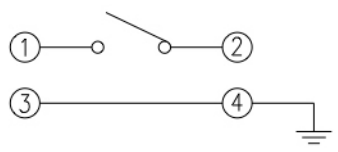

G-Switch Electronic (HongKong) CO.,Ltd.

| | | | | | |
|--|--------------------------|-----------------|-------------------|------------|------------|
| Unless otherwise specified, Tolerance: X. ±0.30 X.x ±0.20 X.xx ±0.15 X.xxx ±0.10 Angles ±3° | DESIGN FengFengChen | DATE 2019.05.29 | Molde code: | | |
| | CHECKED | DATE | GT-TC206X-HXXX-LX | | |
| | APPROVED | DATE | | | |
| | http://www.dg-switch.com | | | REV.: X1 | SCALE: 4:1 |
| TEL:0769-82388879 | | | SIZE: A4 | SHEET: 1/1 | |